

Called the Mountain Survey Claimed by
Barnum Gilbreath and Company - so said

Ludwick Curtis

Peter Shoffstall
Gate

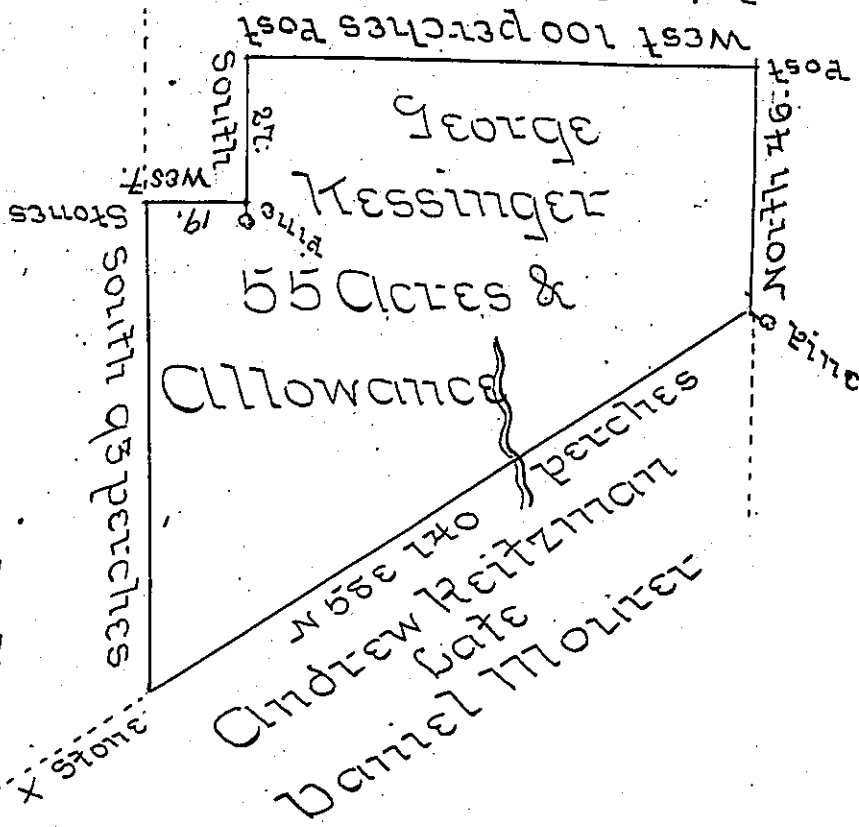

By Virtue of a Warrant dated the Seventeenth day of
June 1794 Surveyed the Ninth day of May 1804 for
George Kissinger the above described Tract of Land
Situate in Upper Paxton Township Dauphin County
Containing Fifty Five Acres and Allowance of Six
Per Cent for Roads &c

Samuel Cochran Esquire } Thomas Clark U.S.
Surveyor General Pennsylvania }

Note the above Tract of land is Claimed by Chris-
tian Shoffstall by his Improvement which is
a small Cabben and about three perches in
fence sowed with Wheat by the Best Information
the said Cabben was made in the month of March
1803. I went to this Cabben and no person lived
therein nor no Appearance thereof

Thomas Clark U.S.

Warrant dated 17th day of June 1793

IN TESTIMONY that the above is a copy of the original remaining on file in
the Department of Internal Affairs of Pennsylvania, made
conformably to an Act of Assembly approved the 16th day of
February, 1833, I have hereunto set my Hand and caused
the Seal of said Department to be affixed at Harrisburg,
this sixteenth day of June 1905.

George D. Brown
Secretary of Internal Affairs.